



Sleeper Cab, CAS 40 shown (optional extra)

MODELS

F-609ST

F-611ST

- MACK THERMODYNE DIESEL
- FRONT AXLE FORWARD
- SHORT BUT ROOMY CAB
- MACK BUILT COMPONENTS

STANDARD EQUIPMENT

WHEELBASE	144" (LP 170"; CA 122")	
ENGINE: (MACK Diesel)	F-609ST	F-611ST
Model (Thermodyne)	END 711	ENDT 673
Type (6 cyl.)	Naturally aspirated	Turbocharged
Bore and stroke	5" x 6"	4 7/8" x 6"
Piston disp., cu. in.	707	672
Brake h.p. at rpm	211 @ 2100	211 @ 2100
Max. torque at rpm	602 @ 1350	605 @ 1500
Lube oil filter (12 qts.)....	Comb. full-flow by-pass	
Lube oil Cooler	Standard	
Air cleaner	Oil bath type	
Radiator, frontal area ...	700 sq. in.	
Water capacity, qts. ...	49	51
Fuel pump (APE)	Multiple unit	
FUEL TANK	51 gal. , left side, steel, rd.	
ELECTRICAL SYSTEM: Generator	12 Volt, 55 Amp.	
Starting system	12 Volt	
Batteries (4 H group)	(4) 6 Volt	
Plates per cell 23; Amp. hr. @ 20 hr. rate.....	160	
CLUTCH: (MACK)	CL 28	
Type	Single-plate, dry, 14 7/8" O.D.	
Area of engagement, sq. in.	253	
TRANSMISSION: (MACK)	TRD 722	
Type	Ten-speed, direct, Duplex	
DRIVESHAFT:		
Make and size	Spicer; 1700; 3 1/2" OD	
FRONT AXLE: (MACK)	FA 534	

Automatic radiator shutters
Automatic reset circuit breakers
Bumper, flush type
Cab roof vent
Headlights and parking lights
Horn, electric, single tone
I.C.C. & Marker lights
Low air pressure indicator, buzzer

CHASSIS EQUIPMENT
Rear view mirror, two, West Coast type
Shock absorbers, front direct type
Stop and tail light
Sun visor, left side
Tachometer, single hand
Thermostat, 170°
Trailer-conn., semi-trailer

Turn signals, front (with 4-way flasher)
Undercoating
Vertical exhaust
Voltmeter
Wheel wrench and handle
Windshield glass, Solex
Windshield wipers, dual, air, single motor

SIX WHEEL MACK DIESEL C.O.E. TRACTOR

BOGIE: (MACK)	SWDL 56
Carriers (Dual Reduction)	CRDP 92 & CRD 93
Ratios	4.17, 4.50, 4.76, 5.13, 5.73, 6.34, 7.00, 7.49

Faster ratios are for optional ENDD 711 (1950 rpm)

SPRINGS	Front	Rear
Size	54" x 3 1/2"	50" x 4"
Leaves, no. & thickness....	10 @ 0.323"	9 @ 0.625"

BRAKES: Type	Air
Front	16 1/4" x 3" (204 sq. in.)
Rear	16 1/2" x 6" (828 sq. in.)
Parking	12" x 5" (139 sq. in.)
Air Compressor	Tu-Flo 500 (12 cu. ft.)
Air reservoir capacity	2960 cu. in. (approx.)

WHEELS & TIRES:	
Wheels	Cast, spoke
Tires	10.00-20 (12P), 7.5 Rims

STEERING GEAR: Model	SG 261
Steering wheel diameter; ratio.....	22"; 28.4:1

FRAME: Size	9" x 3 1/4" x 1/4"
Material	Chrome-manganese steel, heat-treated
Section Modulus	9.76
Resisting bending moment	878,400 in. lbs. per rail

CAB: (MACK)	CA 38
Type (50.5" BBC)	Cab-over-engine

STANDARD CHASSIS WEIGHT (LBS.):

(F-609ST) Front 6,820; Rear 6,845; Total 13,665
(F-611ST) Front 6,820; Rear 6,855; Total 13,675

MACK TRUCKS, INC.

OPTIONAL EQUIPMENT

WHEELBASE:.....165", †186", 244"

†Minimum wheelbase with 5-Speed Transmission and Auxiliary

ENGINE: (MACK Diesel) (F-609).....ENDT 711

HP @ 1950 rpm (gov.).....195

Max. torque @ 1350 rpm.....602 lb.-ft.

Note: Lube oil cooler is omitted, intake manifold is conventional.

ENGINE: (MACK Diesel) (F-611).....ENDT 673B

H.P. @ 2100 rpm (gov.).....250

Max. torque @ 1500 rpm.....701

CLUTCH: (MACK).....CL 50 (with clutch brake)

Type.....Two-plate, dry, 14" OD (416 sq. in.)

TRANSMISSION: (MACK)

TRD 7220.....9-spd., overgear, Duplex

TRD 7225.....10-spd., direct, Unishift

TRD 72250.....9-spd., overgear, Unishift

TRT 722.....15-spd., direct, Triplex

TRT 7220.....13-spd., overgear, Triplex

TR 7220 & BL 8031P.....5-spd., overgear with 3-spd. aux.

TRQ 7220.....18-spd., overgear, Quadruplex

Overgear transmission required when GCW exceeds 73,000 lbs.

FRONT AXLE: (MACK)

FA 535.....Springs, (12) .323"

FA 532.....Springs, (11) .360"

FA 5341, FA 5351, FA 5321.....*No brakes

*Customer responsibility

Springs, heavy duty, FA 534 (12) .323" FA 535 (11) .360" FA 532 (14) .360"

BOGIE: (MACK) same as except for

SWDL 561.....SWDL 56.....7" brakes

SWDL 563.....SWDL 56.....Timken 6" brakes

SWDL 564.....SWDL 56.....Timken 7" brakes

SWDL 75.....SWDL 56.....Inverted Camel-back springs

SWDL 751.....SWDL 75.....7" brakes

SWD 75.....SWDL 75.....Timken 6" brakes

SWD 751.....SWDL 75.....Timken 7" brakes

SPRINGS (SWDL 75, SWD 75) 50" x 4"; 8 leaves @ 0.625"

Carriers and ratios same as standard

CHASSIS EQUIPMENT

Air starting T-bar; American Metal, Unison-Action; General, #107

Automatic drain valve Exhaust brake

Bogie spacing, 55" (SWDL 56 series) Front wheel brake limiting valve

Break-away safety valve Hand control valve

Cab air conditioning, roof mounted Helper seat (for CA 38)

Cab heater, 28,000 btu (std. cab) Horn, air, twin or single

Cab heaters, two, 36,400 total) btu (sleeper cabs) Horn, electric, dual tone

Chrome plated grill Hubodometer

Driver's seat — Bostrom, Viking Hydraulic jack 8- or 12-ton

Power steering Pyrometer Radiator, 1000 sq. in. Rider's seat arm rest Sleeper bunk safety strap Spring loaded parking brake (with or w/o std. driveshaft brake) Step for left side, round fuel tank (for access to rear of cab) Stop and tail light, extra Sun visor, right side Tachograph (RPM and/or MPH) Tow shackle, bumper mt'd. (removable) Trailer conn., full trailer (no hose) Turn signals, rear (loose) Underframe exhaust Wig-Wag low air pressure indicator Window (rear) in sleeper cabs Windshield washers

Specifications subject to change without notice. Illustrations are not necessarily a representation of standard specifications.

MODELS F-609ST & F-611ST

BRAKES: (MACK)

FA 535, FA 532.....16½" x 4" (276)

SWDL 75.....16½" x 6" (828)

SWDL 561, 751.....16½" x 7" (952)

BRAKES: (Timken, Stopmaster)

SWDL 563, SWD 75.....15" x 6" (754)

SWDL 564, SWD 751.....15" x 7" (880)

Timken brakes include automatic brake adjustment, four spring loaded, fail safe auxiliary brake units per bogie, STANDARD driveshaft brake omitted.

FRAME: (Required for 244" WB)

Size.....10½" x 3¼" x ¼"

Material.....Chrome-manganese steel, heat-treated

Section Modulus.....11.83

Resisting bending moment.....1,064,700 in. lbs. per rail

ELECTRICAL SYSTEMS: Starting.....24 Volt

Alternator.....12 Volt, 60 Amp. (heavy-duty)

Alternator.....12 Volt, 85 Amp. (heavy-duty)

CAB: (MACK)

CAS 39.....Sleeper, incl. mattress (72.5" BBC)

CAS 40.....Sleeper, incl. mattress (80.5" BBC)

Cabs include: Helper seat and arm rest; sleeping compartment curtain

WHEELS & TIRES

Disc (7.5 Rims).....Alum.; Hi-Tensile or Accu-Ride

(8.0 Rims).....Steel

Tires and Rims.....10.00-22 (12P), 7.5

11.00-20 (12P), 8.0

FUEL TANKS: (gallons)

Steel, Round.....51, right side

The following are in place of standard

Aluminum, Round.....70, one each side

Steel, Round.....70, one each side

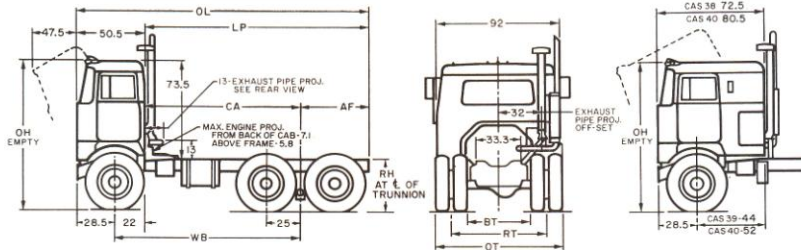

F-609, F-611: (A) 15" (B) 7.1" (C) 8.5"

WB	Standard Cab		Sleeper Cab		Sleeper Cab		AF	OL	Turning Circle Dia. (Outer edge of tire) Est.	
	CA 38	CAS 39	LP	CA	LP	CA			Right	Left
144	170	122	148	100	140	92	48	220.5	57 ft.	57 ft.
165	191	143	169	121	161	113	48	241.5	65 ft.	65 ft.
186	270	164	248	142	240	134	106	320.5	71 ft.	71 ft.
244	342	222	320	200	312	192	120	392.5	88 ft.	88 ft.

Chassis dimensions are in inches and are for standard chassis unless otherwise denoted.

TIRE SIZE	OH Approx.	RH				OT
		Empty		Loaded		
		SWDL 56	SWDL 75	SWDL 56	SWDL 75	
10.00-20	112.1	40.5	40.6	37.9	38.1	95.3
10.00-22	113.1	41.5	41.6	38.9	39.1	95.3
11.00-20	112.7	41.1	41.2	38.3	38.5	96

Frame heights are subject to variations: 1" empty, ½" loaded.