



Sleeper Cab, CAS 40 shown (optional extra)

MODEL F-715ST

- MACK V-8 DIESEL
- FRONT AXLE FORWARD
- SHORT BUT ROOMY CAB
- MACK BUILT COMPONENTS

STANDARD EQUIPMENT

WHEELBASE	144" (LP 170"; CA 122")
ENGINE: (MACK Diesel).....	END 864A, Thermodyne
Type	Naturally aspirated, V8
Bore and stroke	5" x 5½"
Piston displacement, cu. in.	864
Brake horsepower at 2300 rpm	255
Max. torque at 1700 rpm	639 lb.-ft.
Lube oil filter (12 qts.)	Comb. full-flow by-pass
Lube oil cooler	Standard
Air cleaner	Oil bath type
Radiator, frontal area	1000 sq. in.
Water capacity, qts.55
Water filter	Perry
Fuel pump (PSM)	Single plunger
FUEL TANK	51 gal. , left side, steel, rd.
ELECTRICAL SYSTEM: Generator	12 Volt, 55 Amp.
Starting system	12 Volt
Batteries (group 4 H)	(4) 6 Volt
Plates per cell 23; Amp. hr. @ 20 hr. rate.....	160
CLUTCH: Model	CL 58
Type	Single-plate, dry, 16½" O.D.
Area of engagement, sq. in.....	310 (approx.)
TRANSMISSION (MACK)	TRD 722
Type	Ten-speed, direct, Duplex
DRIVESHAFT:	
Make and size.....	Spicer; 1700; 3½" OD
FRONT AXLE: (MACK)	FA 534

SIX WHEEL MACK V-8 DIESEL C.O.E. TRACTOR

BOGIE: (MACK)	SWDL 56
Carriers (Dual Reduction)	CRDP 92 & CRD 93
Ratios	4.17, 4.50, 4.76, 5.13, 5.73, 6.34, 7.00, 7.49
<i>Faster ratios shown are for optional ENDD 864 (2000 rpm)</i>	
SPRINGS,	
Size	Front 54" x 3½" Rear 50" x 4"
Leaves, no. & thickness....	10 @ 0.323" 9 @ 0.625"
BRAKES: Type	Air
Front	16½" x 3" (204 sq. in.)
Rear	16½" x 6" (828 sq. in.)
Parking	12" x 5" (139 sq. in.)
Air Compressor	Tu-Flo 500 (12 cu. ft.)
Air reservoir capacity	2960 cu. in. (approx.)
WHEELS & TIRES:	
Wheels	Cast, spoke
Tires	10.00-20 (12P), 7.5 Rims
STEERING GEAR: Model	SG 261
Steering wheel diameter; ratio	22"; 28.4:1
FRAME: Size	9" x 3¼" x ¼"
Material	Chrome-manganese steel, heat-treated
Section Modulus	9.76
Resisting bending moment	878,400 in. lbs. per rail
CAB: (MACK)	CA 38
Type (50.5" BBC)	Cab-over-engine
STANDARD CHASSIS WEIGHT (LBS.):	
Front 7,060; Rear 6,865; Total 13,925	

CHASSIS EQUIPMENT

Automatic radiator shutters
Automatic reset circuit breakers
Bumper, flush type
Cab roof vent
Headlights and parking lights
Horn, electric, single tone
I.C.C. & Marker lights
Low air pressure indicator, buzzer

Rear view mirror, two, West Coast type
Shock absorbers, front direct type
Stop and tail light
Sun visor, left side
Tachometer, single hand
Thermostat, 170° (two)
Trailer conn., semi-trailer

Turn signals, front
(with 4-way flasher)
Undercoating
Vertical exhaust
Voltmeter
Wheel wrench and handle
Windshield glass, Solex
Windshield wipers, dual, air, single motor

MACK TRUCKS, INC.

OPTIONAL EQUIPMENT

MODEL F-715ST

WHEELBASE165", †186", 244"

(See dimensional chart for LP & CA)

†Minimum wheelbase with 5-Speed Transmission and Auxiliary

ENGINE: (MACK Diesel) (Thermodyne).....ENDD 864

HP @ 2000 rpm (gov.)237

Max. torque @ 1400 rpm.....685 lb.-ft.

CLUTCH: (MACK)CL 50 (with clutch brake)

TypeTwo-plate, dry, 14" O.D.

Area of engagement, sq. in.416

TRANSMISSION: (MACK)

TRD 72209-spd., overgear, Duplex

TRD 722510-spd., direct, Unishift

TRD 722509-spd., overgear, Unishift

TRT 72215-spd., direct, Triplex

TRT 722013-spd., overgear, Triplex

TR 7220 & BL 8031P5-spd., overgear with 3-spd. aux.

TRQ 722018-spd., overgear, Quadruplex

Overgear transmission required when GCW exceeds 73,000 lbs.

FRONT AXLE: (MACK)

FA 535Springs, (12) .323"

FA 532Springs, (11) .360"

FA 5341, FA 5351, FA 5321*No brakes

*Customer responsibility

Springs, heavy duty, FA 534(12) .323"

FA 535(11) .360"

FA 532(14) .360"

BOGIE: (MACK) same as except for

SWDL 561SWDL 567" brakes

SWDL 563SWDL 56Timken 6" brakes

SWDL 564SWDL 56Timken 7" brakes

SWDL 75SWDL 56Inverted Camel-back springs

SWDL 751SWDL 757" brakes

SWD 75SWDL 75Timken 6" brakes

SWD 751SWDL 75Timken 7" brakes

SPRINGS (SWDL 57, SWD 57) 50" x 4"; 8 leaves @ 0.625"

Carriers and ratios same as standard

BRAKES: (MACK)

FA 535, FA 53216½" x 4" (276)

SWDL 7516½" x 6" (828)

SWDL 561, 75116½" x 7" (952)

BRAKES: (Timken, Stopmaster)

SWDL 563, SWD 7515" x 6" (754)

SWDL 564, SWD 75115" x 7" (880)

Timken brakes include automatic brake adjustment, four spring loaded, fail safe auxiliary brake units per bogie, STANDARD driveshaft brake omitted.

FRAME: (Required for 244" WB)

Size10½" x 3¼" x ¼"

Section Modulus11.83

Resisting bending moment1,064,700 in. lbs. per rail

ELECTRICAL SYSTEMS: Starting24 Volt

Alternator12 Volt, 60 Amp. (heavy-duty)

Alternator12 Volt, 85 Amp. (heavy-duty)

CAB (MACK)

CAS 39Sleeper, incl. mattress (72.5" BBC)

CAS 40Sleeper, incl. mattress (80.5" BBC)

Cabs include: Helper seat and arm rest; sleeping compartment curtain

WHEELS & TIRES

Disc (7.5 Rims)Alum.; Hi-Tensile or Accu-Ride

(8.0 Rims)Steel

Tires and Rims10.00-22 (12P), 7.5

11.00-20 (12P), 8.0

FUEL TANKS: (gallons)

Steel, Round51, right side

The following are in place of standard

Aluminum, Round70, one each side

Steel, Round70, one each side

CHASSIS EQUIPMENT

Air starting

Automatic drain valve

Bogie spacing, 55" (SWDL 56 series)

Break-away safety valve

Cab air conditioning, roof mounted

Cab heater, 28,000 btu (std. cab)

Cab heaters, two 36,400

(total) btu (sleeper cabs)

Chrome plated grill

Driver's seat — Bostrom, Viking

T-bar; American Metal,

Unison-Action; General, #107

Front wheel brake limiting valve

Hand control valve

Helper seat (for CA 38)

Horn, electric, dual tone

Horn, air, twin or single

Hubodometer

Hydraulic jack 8- or 12-ton

Power steering

Pyrometer

Rider's seat arm rest

Sleeper bunk safety strap

Spring loaded parking brake

(with or w/o std, driveshaft brake)

Step for left side, round fuel tank

(for access to rear of cab)

Stop and tail light, extra

Sun visor, right side

Tachograph (RPM and/or MPH)

Tow shackle, bumper mt'd.

(removable)

Trailer conn., full trailer (no nose)

Turn signals, rear (loose)

Underframe exhaust

Wig-Wag low air pressure indicator

Window (rear) in sleeper cabs

Windshield washers

Specifications subject to change without notice. Illustrations are not necessarily a representation of standard specifications.

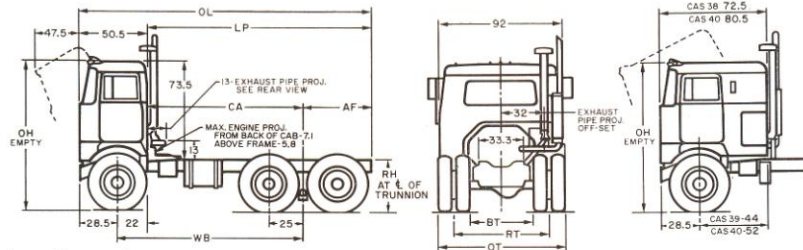

F-715: (A) 14.4" (B) 9" (C) 4.5"

WB	Standard Cab		Sleeper Cab		Sleeper Cab		AF	OL	Turning Circle Dia. (Outer edge of tire) Est.	
	LP	CA	LP	CA	LP	CA			Right	Left
144	170	122	148	100	140	92	48	220.5	57 ft.	57 ft.
165	191	143	169	121	161	113	48	241.5	65 ft.	65 ft.
186	270	164	248	142	240	134	106	320.5	71 ft.	71 ft.
244	342	222	320	200	312	192	120	392.5	88 ft.	88 ft.

Chassis dimensions are in inches and are for standard chassis unless otherwise denoted.

TIRE SIZE	OH Approx.	RH				OT
		Empty		Loaded		
		SWDL 56	SWDL 75	SWDL 56	SWDL 75	
10.00-20	112.1	40.5	40.6	37.9	38.1	95.3
10.00-22	113.1	41.5	41.6	38.9	39.1	95.3
11.00-20	112.7	41.1	41.2	38.3	38.5	96

Frame heights are subject to variations: 1" empty, ½" loaded.