



E8209RS

MACK TRUCKS  WORLDWIDE, LTD.

MODEL R-609RSX

- MACK THERMODYNE DIESEL FUEL ECONOMY
- EXTRA ROOMY CAB INTERIOR
- STEEL BUTTERFLY HOOD AND FLAT FENDERS
- MACK BUILT COMPONENTS

STANDARD EQUIPMENT

WHEELBASE 171" (LP 144"; CA 96")

ENGINE: (MACK Diesel) **END 711, Thermodyne**
 Type Naturally aspirated, 6 cyl.
 Bore and stroke 5" x 6"
Piston displacement, cu. in. **707**
Brake horsepower at 2100 rpm **211**
Max. torque @ 1350 rpm **602 lb.-ft.**
 Lube oil filter (12 qts.) Comb. full-flow by-pass
 Air cleaner Oil bath type
 Radiator, frontal area 1000 sq. in.
 Thermostat, to open 170°
 Fuel pump (APE) Multiple unit

FUEL TANK **55 gal.**, right side, steel, rect., step

ELECTRICAL SYSTEM: Generator **12 Volt, 55 Amp.**
 Starting system 12 Volt
 Batteries (group 4H) (4) 6 Volt
 Plates per cell 23; Amp. hr. @ 20 hr. rate 170

CLUTCH: (MACK) **CL 28**
 Type Single-plate, dry, 14 $\frac{7}{8}$ " O.D.
 Area of engagement, sq. in. 253

TRANSMISSION: (MACK) **TRD 722**
 Type Ten-speed, direct, Duplex

DRIVESHAFT:
 Make and size Spicer; 1700; 3 $\frac{1}{2}$ " O.D.

FRONT AXLE: (MACK) **FA 532**

Air intake system, outside—underhood
 Automatic radiator shutters
 Automatic reset circuit breakers
 Bumper, extended
 Cab roof vent, two-way
 Headlights and parking lights
 Hood—steel butterfly & flat fenders
 Horn, electric, single tone

I.C.C. & Marker lights
 Low air pressure indicator, buzzer
 Rear view mirrors, two, West Coast type
 (black enamel finish)
 Seat belt anchors
 Steering column, adjustable
 Stop and tail light
 Sun visor, right side

CHASSIS EQUIPMENT

SIX WHEEL • MACK DIESEL

BOGIE: (MACK) **SWD 68**
 Carriers (Dual Reduction) CRDP 112 & CRD 113
 Ratios 6.34, 7.00, 7.49, 8.24, 9.15
 Note: 54" BOGIE spacing.

SPRINGS:

	Front	Rear
Size	50 $\frac{1}{4}$ " x 3 $\frac{1}{2}$ "	54" x 5"
Leaves, no. & thickness	13 @ .360"	13 @ .788"

BRAKES: Type **Air**
 Front 16 $\frac{1}{2}$ " x 4" (276 sq. in.)
 Rear 16 $\frac{1}{2}$ " x 6" (828 sq. in.)
 Parking 12" x 5" (139 sq. in.)
 Air Compressor Tu-Flo 500 (12 cu. ft.)
 Air reservoir capacity 3000 cu. in. (approx.)

WHEELS & TIRES:
 Wheels Cast spoke
 Tires *11.00-22 (12P) 8.0 Rims
 *SWD 68 & SWD 681 only; overall width exceeds 96"

STEERING GEAR: Model **SG 26**
 Steering wheel diameter 22"
 Ratio 28.4:1

FRAME: Size **10 $\frac{3}{8}$ " x 3 $\frac{1}{4}$ " x 5/16"**
 Reinforcement $\frac{1}{4}$ " Inside channel
 Material Chrome-manganese steel, heat-treated
 Section Modulus 24.3
 Resisting bending moment 2,187,000 in. lbs. per rail

CAB: (MACK) **CAR 36**
 Type (109" BBC) Conventional, two-man,
 Right hand drive

STANDARD CHASSIS WEIGHT (LBS.): Est.
 Front 7,287; Rear 7,762; Total 15,049

MACK TRUCKS, INC.

OPTIONAL EQUIPMENT

MODEL R-609RSX

WHEELBASE 183", 223"
 (See dimensional chart for LP & CA)
CLUTCH: (MACK)
 Model CL 58
 Type Single-plate dry, 16½" O.D.
 Area of engagement, sq. in. 312

TRANSMISSION: (MACK)
 TRQ 7220 18-spd., overgear, Quadruplex
 TR 7220 & BL 8031 P 5-spd., overgear, 3-spd. Aux.
 TR 7220 & BL 8341 C 5-spd., overgear, 4-spd. Aux.
 Power tower for B/L 8031 P or 8341 C Aux.

FRONT AXLE: (MACK)
 FA 600 Springs, (14) .401"
 Springs, heavy duty, FA 600 (16) .401"

BOGIE: (MACK)
 SWD 681 same as SWD 68 except for 7" brakes
 SWD 592 CRDP 95 & CRD 96
 Ratios 8.27; 9.10; 10.11; 11.38
 Brakes, Mack 17¼" x 6" brakes
 SWD 5921 same as SWD 592 except for 7" brakes
 SWD 69 same as SWD 592 except for Air over hydraulic brakes
 Bogie Spacing: SWD 68 & SWD 681 54"
 SWD 592 & SWD 5921 58"
 SWD 69 60"

BRAKES: (MACK) (sq. in.)
 FA 600 17¼" x 5" (355)
 SWD 681 16½" x 7" (952)
 SWD 592 17¼" x 6" (852)
 SWD 5921 17¼" x 7" (995)

BRAKES: (Air over hydraulic) (sq. in.)
 SWD 69 20¼" x 7" (1184)

ELECTRICAL SYSTEM:
 Starting 24 Volt
 Alternator 12 Volt, 60 Amp. (heavy-duty)
 Alternator 12 Volt, 85 Amp. (heavy-duty)

WHEELS & TIRES:
 Cast spoke, steel disc 8.5 Rims
 Tire & Rims 11.00-24 (12) 8.0; 12.00-24 (14) 8.5
 Note: 12.00-24 disc available only with SWD 592, SWD 5921, or SWD 69.

FUEL TANK: (gallons)
 Steel, rect., step 55, left side
 Steel, rect., step 70, left side
 Steel, rect., step 85, left side

CHASSIS EQUIPMENT

Air reservoir, isolated for spring-loaded brakes
 Air starting
 Automatic drain valve
 Brake, alcohol evaporator
 Break-away safety valve
 Cab air conditioner
 Cab heater and defroster, 37,500 btu
 Chrome plated front turn signals
 Chrome plated W.C. rear view mirrors
 Crank shaft adaptor for front end mixer drive

Driver's Seat—Bostrom, West Coaster or Viking T-bar; General, #107; American Metal, Unison Action
 Engine water filter, Perry
 Flywheel Power Take-off (N/A with CL 58)
 Front wheel brake limiting valve
 Hand control valve
 Horn, air, twin or single
 Horn, electric, dual tone
 Hubodometer

Hydraulic jack, 8- or 12-ton
 Low oil pressure warning light
 Power Divider Lock-out
 Power steering
 Pyrometer, exhaust
 Radiator guard, plate type
 Reflectors, one each side cab rear
 Riders seat (cab step right side incl.)
 Seat belts
 Spring loaded parking brake, incl. warning light in cab (with or w/o std. driveshaft brake)

Stop and tail light, extra
 Sun visor, left side
 Tachograph (RPM and/or MPH)
 Trailer conn., semi-trailer
 Turn signals, rear (loose)
 Vertical exhaust
 Water temp. warning light
 Wig-wag low air pressure indicator
 Window power lift, left side
 Windshield washers

Specifications subject to change without notice. Illustrations are not necessarily a representation of standard specifications.

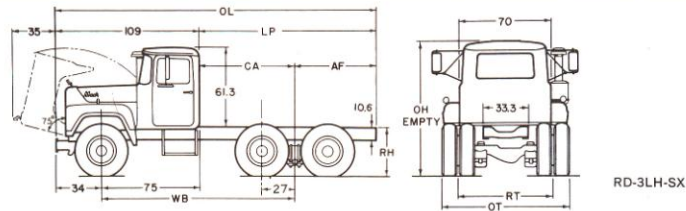

WB	LP	CA	AF	OL	Turning Circle Dia. (Outer Edge of tire) Approx.	
					Left	Right
171	144	96	48	247	53 ft.	49 ft.
183	168	108	60	271	58 ft.	51.5 ft.
223	240	148	92	343	70 ft.	63 ft.

TIRE SIZE	OH Approx.	RH		OT	RT
		Loaded	Empty		
11.00-22	108.6	41.3	42.1	97.4	71.1
11.00-24	109.6	42.3	43.2	99.0	73.6
12.00-24	110.4	43.0	43.9	104.4	77.00

Chassis dimensions are in inches and are for standard chassis unless otherwise denoted.

Frame heights are subject to variation: 1" empty, ½" loaded.

MACK TRUCKS WORLDWIDE LIMITED

MACK TRUCKS, INC.

ALLENTOWN, PA. "THE TRUCK CAPITAL OF THE WORLD"